

# SUBMITTAL DATA

**Schwank**  
INNOVATIVE HEATING SOLUTIONS



## STR-JZ

### POSITIVE PRESSURE SERIES GAS FIRED INFRA-RED TUBE HEATERS

PROJECT:	
ENGINEER:	
CONTRACTOR:	
DISTRIBUTOR:	
SCHWANK MODEL #:	
FUEL:	
APPROVED BY:	
DATE:	
APPROVAL #:	



**NOTICE:**

*Schwank reserves the right to make changes to equipment and specifications without obligation or notification.*

*This publication, or parts thereof, may not be reproduced in any form, without prior written consent from Schwank. Unauthorized use or distribution of this publication is strictly prohibited.*

*Schwank Group  
5285 Bradco Boulevard,  
Mississauga, Ontario,  
L4W 2A6  
phone: (905) 712-4766  
fax: (905) 712-8336*

*Schwank Inc.  
PO Box 988  
Waynesboro,  
Georgia,  
USA 30830  
Phone: (706) 554-6191  
Fax: (706) 554 9390*

*e-mail: [info@schwankgroup.com](mailto:info@schwankgroup.com)*

*<http://www.schwankgroup.com>*

<u>TABLE 1: MODEL CONFIGURATIONS</u>		TOTAL TUBE LENGTH	CAPACITY (BTU/HR) 0 to 4,500 ft. ABOVE SEA LEVEL	TURBULATOR LENGTH	GAS PRESSURE & ELECTRICAL	FLUE & AIR VENT	SHIPPING WEIGHT (LBS.)
STR-JZ-60-30		30' 8"	60,000	14'	<u>LINE MINIMUM</u> 5" W.C. N.G. 11" W.C. L.P.	4"	154
STR-JZ-60-20		21' 0"		14'	<u>LINE MAXIMUM</u> 14" W.C. N.G. 14" W.C. L.P.		111
STR-JZ-45-20		21' 0"	45,000	5'	<u>MANIFOLD</u> 3½" W.C. N.G. 10" W.C. L.P.  ½" GAS INLET		111
STR-JZ-45-10		11' 4"		5'	ELECTRICAL 120V, 60 HZ 145 VA		68

### TOP VIEWS OF SYSTEMS

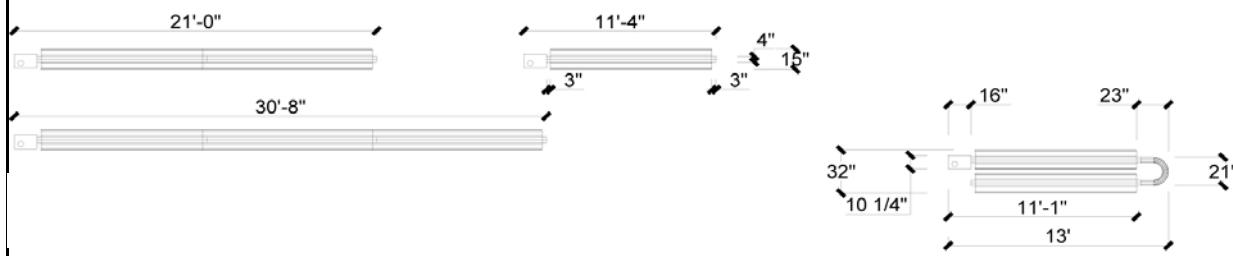

<b><u>TABLE 2</u></b> <b><u>COMPONENT QUANTITIES</u></b> <b><u>PER HEATER MODEL</u></b>	<b><u>STR-JZ 45-10</u></b>	<b><u>STR-JZ 45-20</u></b>	<b><u>STR-JZ 60-20</u></b>	<b><u>STR-JZ 60-30</u></b>
10' ALUMINIZED SWAGED TUBE w/ FLANGE	1	1	1	1
10' SWAGED STEEL TUBE w/ EMISSIVE COATING	0	1	1	2
9'8" (116") FOCUS SHIELD REFLECTOR	1	2	2	3
ALUMINIZED COUPLER	0	1	1	2
END PLATE HANGER	2	2	2	2
TUBE / REFLECTOR WEBBED HANGER	0	1	1	2
REFLECTOR STABILIZER	3	6	6	9
5'ALUMINIZED STEEL TURBULATORS	1	1	0	0
10' ALUMINIZED STEEL TURBULATOR	0	0	0	0
14' ALUMINIZED STEEL TURBULATOR	0	0	1	1
QUANTITY OF HEATERS ON THIS PROJECT				

### **CUT-AWAY BURNER VIEW**

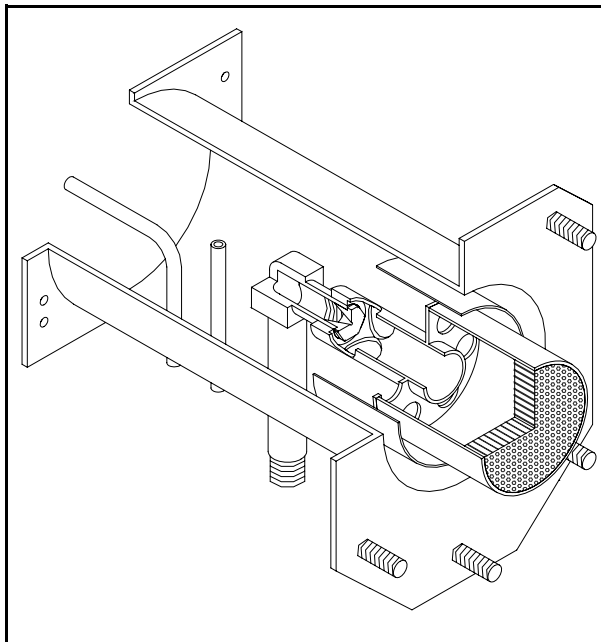

<b><u>OPTIONAL ACCESSORIES</u></b>	<b>QUANTITIES ON THIS PROJECT</b>
90 DEGREE SWAGED ELBOW KIT 1 elbow, 2 webbed hangers, 1 coupler	
180 DEGREE SWAGED ELBOW KIT 2 x 90 degree elbow kits - 3 webbed hangers, 2 couplers	
4" ROOF FLUE VENT TERMINAL	
6" ROOF FLUE VENT TERMINAL	
4" WALL FLUE VENT TERMINAL	
6" WALL FLUE VENT TERMINAL	
FLUE VENT TEE (4" x 4" x 6")	
ALUMINIZED STEEL COUPLING KIT FOR TEE	
TRU-TEMP THERMOSTAT	
FLEXIBLE GAS CONNECTOR	

## APPROVED MINIMUM CLEARANCES TO COMBUSTIBLES

MODEL	SUSPENDED AT AN ANGLE UP TO 45 DEGREES				SUSPENDED HORIZONTALLY		
	D	E	F	G	A	B	C
STR-JZ 60	1.5"	1"	17"	34"	2.5"	5.5"	34"
STR-JZ 45	2.25"	1"	24"	32"	2.75"	7"	32"

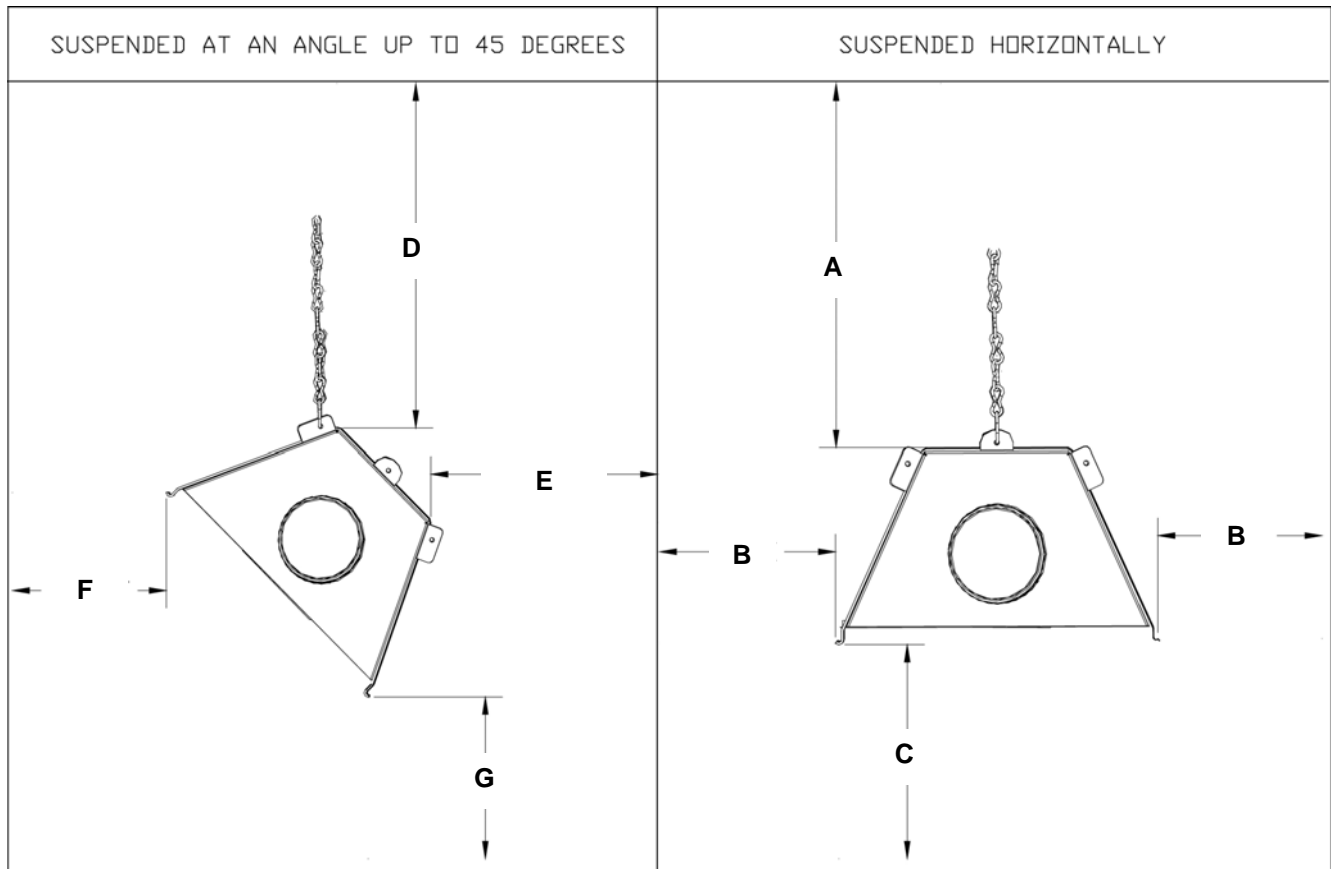

# TYPICAL HANGER & SUPPORT SPACING RECOMMENDATIONS

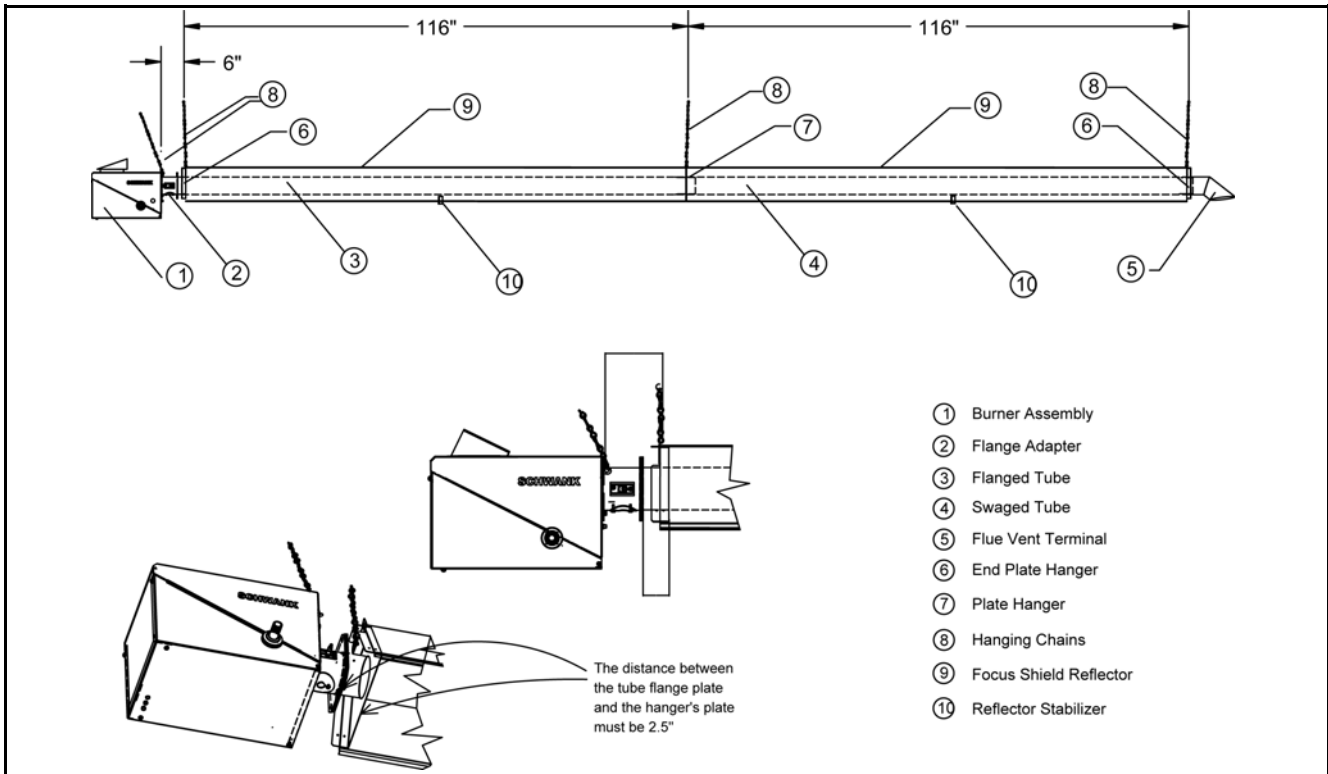

## REFLECTOR STABILIZER

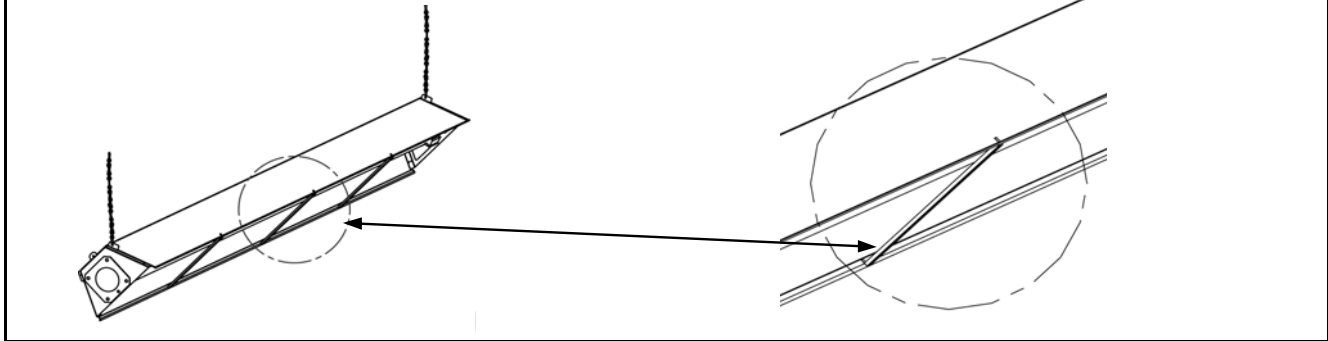

## PLATE HANGER/ELBOW INSTALLATION

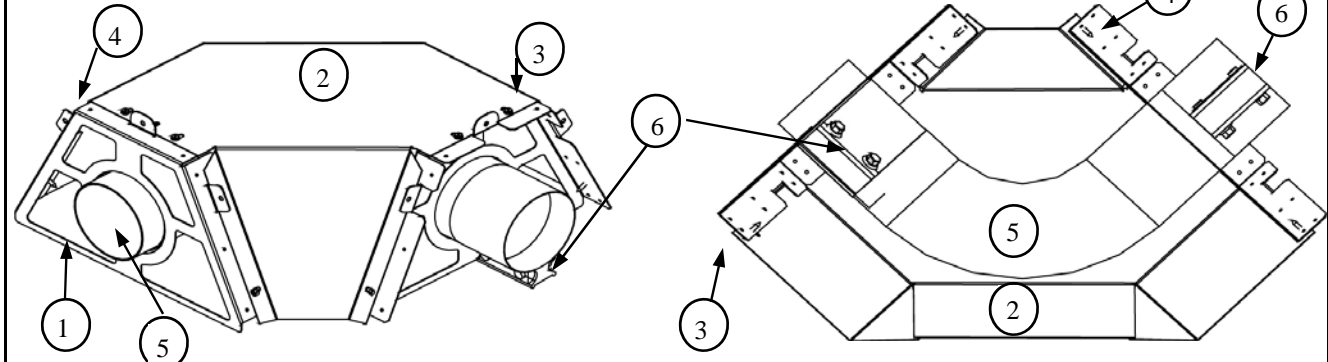

JS-0508-JZ

- 1. Plate-Hanger
- 2. Reflectors
- 3. Plate-Hanger Flange UNDER Reflector

- 4. Plate Hanger Flange to mount UNDER the next Reflector
- 5. 90° Elbow (shown)
- 6. Tube/Elbow Coupler

## COMPONENT DESCRIPTION - STR-JZ

<b>IGNITION</b>	DIRECT SPARK MODULE	-HONEYWELL
		-OTHER
<b>COMBINATION GAS VALVE</b>	HONEYWELL 24 VOLT	-NATURAL GAS 3 ½" W.C. MANIFOLD PRESSURE
		-PROPANE 10" W.C. MANIFOLD PRESSURE
<b>REFLECTORS</b>	REFLECTORS PROTRUDE 1.625" BELOW BOTTOM SURFACE OF TUBE	
	REFLECTORS ARE CLOSED AT START AND END OF EACH STRAIGHT RUN OF TUBES BY MEANS OF END PLATE HANGERS	
<b>TUBES 45 THRU 60 MBTUH INPUT</b>	THE FIRST SECTION IS 10' LONG, 4" DIAMETER, 16 GA. ALUMINIZED STEEL SWAGED ONE END	
	EACH ADDITIONAL SECTION IS 10' LONG, 4" DIAMETER, 16 GA. HOT ROLLED STEEL WITH EMISSIVE COATING SWAGED ONE END	
<b>HANGERS</b>	ONE WEBBED HANGER SUPPORTS EACH 10' OF TUBE, EXCEPT THE FIRST AND LAST TUBES WHICH COMPRISE OF ONE WEBBED HANGER AND ONE END PLATE HANGER.	
<b>COUPLING KIT</b>	ALUMINIZED STEEL COUPLER	
<b>ELBOWS</b>	90 DEGREE ELBOW 4" DIAMETER, 16 GA. ALUMINIZED STEEL, 8 ½" CENTRE RADIUS SWAGED ONE END	
	180 DEGREE ELBOW 4" DIAMETER, 16 GA. ALUMINIZED STEEL, 8 ½" CENTRE RADIUS (ASSEMBLY OF TWO 90 DEGREE ELBOW KITS)	
<b>BURNER HOUSING</b>	BOTTOM FOLDS AWAY, PROVIDING ACCESS FROM TWO SIDES, END AND BOTTOM	
<b>BURNER</b>	INCORPORATES EFFECTILE CERAMIC BURNER HEAD WITH MINIMUM OF 835 FLAME PORTS	
	COMPLETE WITH OPERATION STATUS INDICATOR LIGHTS	
<b>SAFETY SWITCHES</b>	TWO SEPARATE AIR PRESSURE SWITCHES SENSE ADEQUATE COMBUSTION AIR AND BLOCKED FLUE	
<b>BLOWER</b>	COMBUSTION AIR DUCTED DIRECTLY TO INTAKE OF BLOWER	
<b>THERMOSTAT</b>	24 Volt THERMOSTAT IS SUPPLIED WITH HEATER	
	SCHWANK TRU-TEMP SET BACK THERMOSTAT (OPTIONAL)	WITH RADIANT & AMBIENT SENSORS, AND AUTOMATIC UNOCCUPIED MODE SETBACK
<b>TERMINAL BLOCK</b>	ALL WIRING CONNECTIONS BY MEANS OF ONE COMMON TERMINAL BLOCK	
<b>ELECTRICAL CORD</b>	1220mm (4') LENGTH 16/3 ELECTRICAL SUPPLY CORD WITH 3 PIN GROUNDED PLUG	